

# PLAT OF SURVEY

A PARCEL OF LAND BEING SITUATED IN THE SOUTHWEST QUARTER, SECTION 19, TOWNSHIP 6 NORTH, RANGE 3 EAST, PULASKI TOWNSHIP, WILLIAMS COUNTY, OHIO.

FREY-KILLGALLON GROUP LTD  
 DEED VOL. 311 PG 295  
 DEED VOL. 311 PG 298  
 DEED VOL. 311 PG 301  
 DEED VOL. 311 PG 304

NW CORN., SEC. 19

W. LINE, SW 1/4, SEC. 19  
 N 01°02'15" E

S 88°42'13" E 356.15'

3.50 ACRES  
 R/W-1.16 ACRES  
 EXIST. BUILDINGS

### CURVE DATA (STATE ROUTE 2)

$\Delta = 21^\circ 02' 30''$   
 $R = 2291.83' (R), 2287.24' (M)$   
 $T = 425.11'$   
 $L = 839.97'$   
 P.I. STA 162+46.34

NW CORN., SW 1/4, SEC. 19

LICK CREEK  
 CHURCH OF THE BRETHREN  
 DEED VOL. 32 PG 291  
 DEED VOL. 86 PG 37  
 DEED VOL. 177 PG 537  
 DEED VOL. 185 PG 248  
 DEED VOL. 196 PG 347

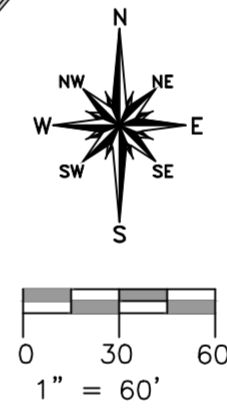

### LEGEND

- PLACED 1/2" REBAR W/ CAP
- × FOUND P.K. NAIL
- POINT ESTABLISHED THIS SURVEY
- ⊗ FOUND RAILROAD SPIKE
- FOUND IRON PIN OR PIPE
- FOUND MONUMENT BOX
- (M) BEARING OR DISTANCE MEASURED THIS SURVEY
- (R) RECORDED DISTANCE OR BEARING FROM ORIGINAL DEED OR SURVEY

GLEN FITZENRIDER  
 DEED VOL. 177 PG 537

C/L CENTER STREET  
 (FORMERLY S.R. 2)

PI STA 162+46.34

BOARD OF EDUCATION  
 BRYAN CITY SCHOOL DISTRICT  
 DEED VOL. 251 PG 225

REFERENCE SURVEYS:  
 VOL. 4R PG. 34  
 VOL. 6R PG. 50  
 VOL. 16R PG. 194  
 VOL. 20R PG. 082  
 RIGHT OF WAY DRAWINGS OF ODOT FOR  
 WIL-2-00-1.13-1.29-3.72, BRYAN FT.  
 WAYNE ROAD, DATE 5-10-1949.

THOMAS R. THOMPSON &  
 LINDA S. PORATH  
 DEED VOL. 299 PG 12

I HEREBY CERTIFY THAT I HAVE SURVEY THE PREMISES SHOWN ON THE PLAT ABOVE. ALL DIMENSIONS ARE SHOWN IN FEET AND DECIMALS THEREOF. SINCE THIS SURVEY DOES NOT INCLUDE A TITLE SEARCH, THERE COULD BE EASEMENTS OR OTHER ENCUMBRANCES UPON THE LAND WHICH ARE NOT SHOWN ON THIS SURVEY PLAT. IF THESE ARE REQUIRED, PLEASE FURNISH THE NECESSARY INFORMATION. THE BEARINGS AND DISTANCES SHOWN ON THE PLAT ABOVE ARE BASED ON STATE PLANE COORDINATES SPC83, ZONE-OHIO NORTH. THIS SURVEY HAS BEEN RECORDED IN VOL. 20R PAGE 83 OF THE WILLIAMS COUNTY SURVEY RECORDS.

*Dennis M. Bell*

DENNIS M. BELL  
 REGISTERED SURVEYOR NO. 6717

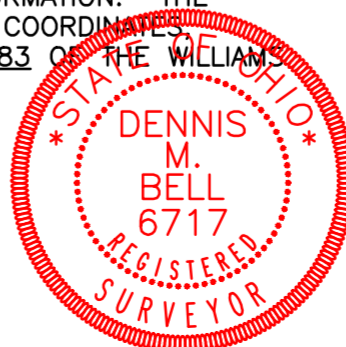

REPLACEMENT COPY 10-6-2020

JOB NO : 03-038	DATE : 3-27-2003
5691 State Route 15 P.O. Box 565 Bryan, Ohio 43506 419 636 2585 fax 419 636 8434	